

HEAVY-DUTY FANS

D T-1000 Series

TURBO FANS

透浦送風機

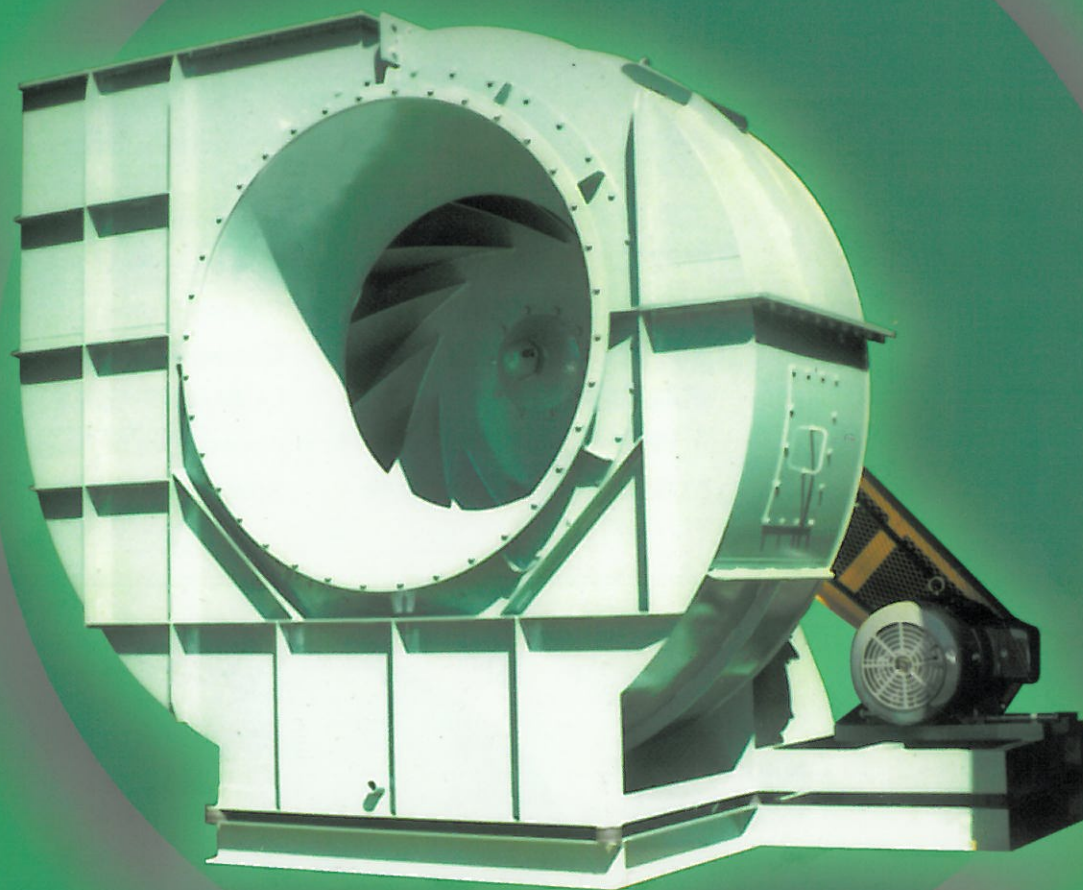

達勝機械股份有限公司
TA SHENG MACHINERY CO.,LTD.

公司介紹 Introduction

達勝公司自1977年創立以來，一直致力於送排風機的設計與製造，是一家專業性的製造廠商。本公司除了提供高品質，高效率，低噪音的送排風機外，也累積豐富的送排風機使用及其應用經驗，協助使用者解決各種實際運轉上發生的問題。

DT系列透浦式送排風機是專為各種工業製程，集塵設備，空氣輸送及工業空調而設計，可適合各種嚴苛的場合。

另外本公司亦可依客戶的需求，設計製造各種風量，壓力及各種特殊用途，型式的送排風機。如有任何送風機的問題，請洽詢達勝公司。

TA SHENG co. devote in designing and manufacturing fans and blowers since 1977 was founded. As a specialist in this field, we not only provide the high quality, high efficiency, and low noise fans and blower, but offer the abundant experiences in fans operations and applications to solve the problems of users which they encountered.

DT series fans are designed for industrial processes, dust collecting, pneumatic conveying and air conditioning. They are especially good for serious applications. Besides, TA SHENG can also design and manufacture the fans and blowers according to the users's specifications which beyond DT series ranges.

主要產品 Main Products

工業用送排風機	Mild Steel Fans & Blowers
多段式高壓鼓風機	Mild Steel Multi-Stage Blowers
單段鑄造型鼓風機	Casting Blowers
多段鑄造型高壓鼓風機	Casting Multi-Stage Blowers
不漏氣風門	Leakless Dampers
送排風機及鼓風機各式附件	Accessories of Fans & Blowers
特殊型送排風機及鼓風機	Special Applications Fans & Blowers

目錄 Contents

公司介紹，目錄	Introduction, Contents	P1
設計及構造	Design & Constructions	P2
技術資料	Technical Data	P5
機型說明及綜合性能	Model Instruction & General Performances	P6
各機型性能曲線表	Performance Curves	P7~12
外形尺寸表	Dimensions	P13~16
風量控制開關外形尺寸	Damper & IVC Dimensions	P17
訂製資料及單位換算	Making Inquiry & Units Conversion	P18

型錄內容若有更改，恕不另行通知。Revision of this catalog will make no additional information.

設計及構造 Design & Constructions

輸送氣體

空氣，蒸氣。
熱氣，廢氣，腐蝕性氣體，含粉塵氣體，可燃性氣體，毒性氣體。

材質

一般碳鋼
耐熱鋼
不銹鋼
鈦，鋁合金，及其它特殊金屬材料。
耐腐蝕內襯：橡膠，玻璃纖維。
耐磨耗處理：耐磨鋼板，耐磨珠料，陶瓷，耐磨金屬噴焊。

氣密性

標準型送排風機：用於一般性氣體輸送，對氣密性無特殊要求。
氣密性（Gas-Tight）送排風機：輸送的氣體必須與外部空氣隔絕的場合。

軸封

V型軸封
多片式軸封
迷宮式軸封
填函式軸封
機械式軸封
水封式軸封

Delivered Gas

Air, Steam.
Hot, flue, erosive, corrosive, dust-content, explosive and toxic gases.

Materials

Carbon steel. Heat-resistant steel.
Stainless steel. Titanium.
Nickel and other special alloys.
Corrosion-resistant coating: Rubber, Fiber-glass.
Wear-resistant treatment: Liner, ceramic, beads of weld, flame spray coating.

Tightness

Standard type fans: Used in normal air or gas delivery, no special requirement on tightness.
Gas-tight fans: Used in which the delivered gas can't leak to environment or air leak into the fans.

Seals

V-Ring seal
Multi-plate seal
Labyrinth seal
Gland packing seal
Mechanical seal
Water seal

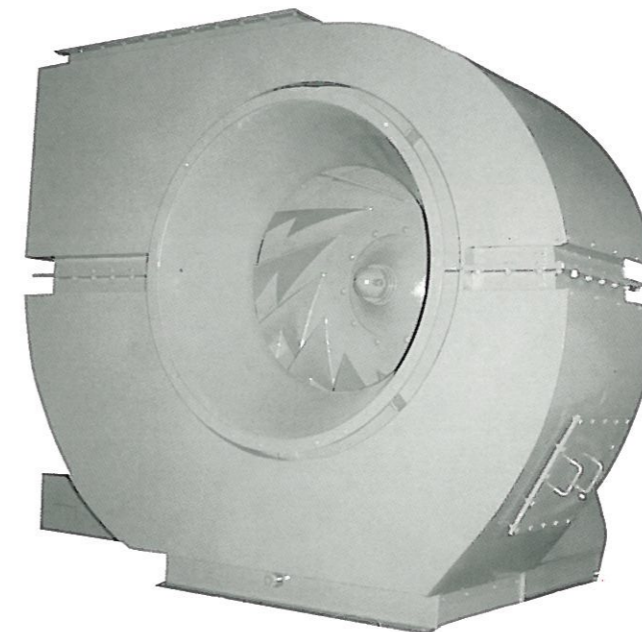

DT-1300S 外包隔音材，可大幅降低外殼傳出的噪音。

DT-1300S with lagging, the noise can be reduced to a great extent.

設計及構造 Design & Constructions

- 葉輪均經精密流場分析，效率高，噪音低。
Impellers are aerodynamically designed for high efficiency and low noise.

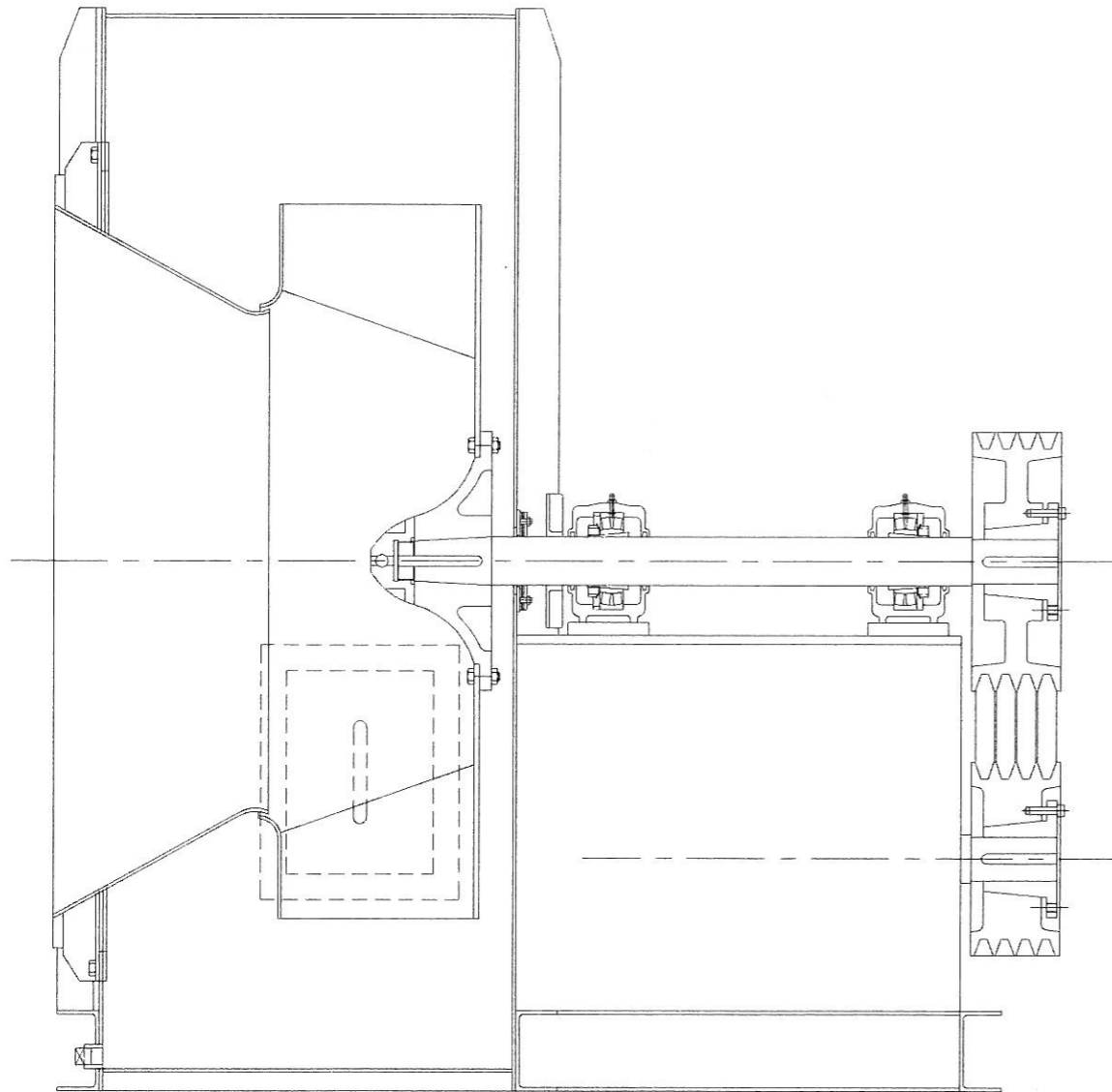

- 外殼附清除孔，不必拆出入口管即可檢查或清洗葉輪。外殼最下方附洩水孔，供洩水用。
Manhole and drain-hole are the standard accessories.

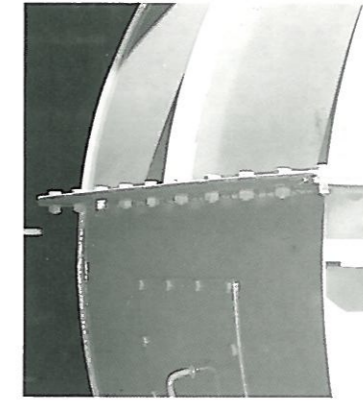
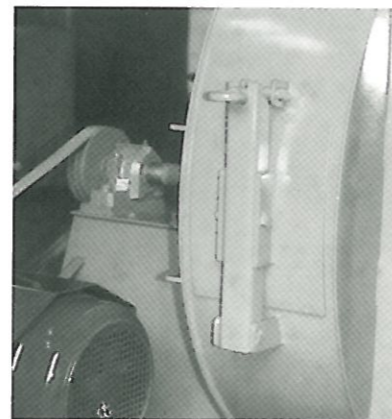

- 外殼渦卷部份採用外部焊接，焊接確實，不虞接縫部位滲水銹蝕。
The outside-welding of casing makes no water penetrating into the adjacent areas and keeps rust-free.

- 轉動部份均經美國製 HOFMANN 電腦動平衡機校正，運轉平穩，振動極微。
The rotating elements are dynamically balanced by "HOFMANN" computer ballancing machings.

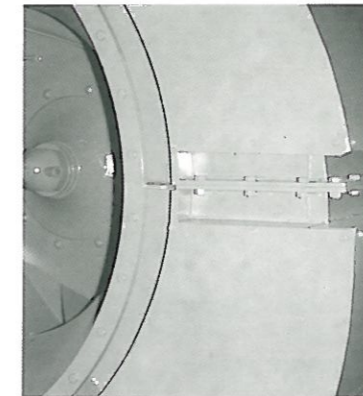

- 葉輪與軸結合採用錐度配合拆卸容易，方便保養。
Taper fits are used at shaft and hub, they make assembly and disassembly easily.

- 輪殼螺帽經特殊設計，安裝葉輪不需敲擊，拆卸時亦不需拔取器。
Patent hub lock nuts, easy to assemble and disassemble when maintenance.

- 全系列採用德國製 "optibelt" 高張力三角皮帶，壽命長，傳動馬力大。
"optibelt" SK wedge belts which made in Germany are used in DT series heavy-duty fans.

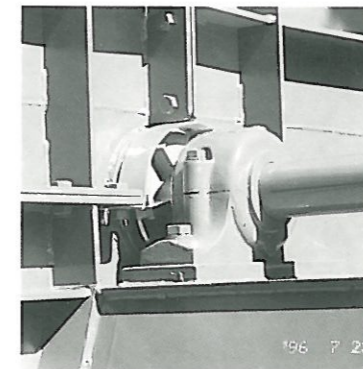

- 外殼採下下分割結合，拆卸葉輪不必動及出入口管，方便保養。
Split casing, disassemble impeller without touch the outlet and inlet ducts

- 採用多片型軸封，氣密性良好。
Multi-plate seal is used, free of gas leakage.

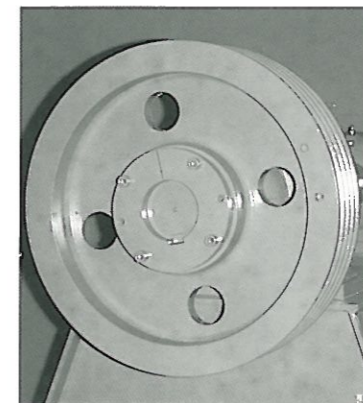

- 皮帶輪與軸結合採用雙錐度軸套，不需拔取器即可輕易拆卸皮帶輪。
The pulleys are fastened to the shaft with taper bushings, disassembling pulleys easiyy without any drawer.

技術資料 Technical Data

● 名詞說明：

風量：指鼓風機入口風量。

靜壓：指鼓風機出口靜壓，入口氣體為標準狀態下的空氣。

標準狀態：20°C，絕對壓力760mmHg，相對濕度65%。又稱STP，此時1m³空氣重量為1.2kg。

基準狀態：0°C，絕對壓力760mmHg，相對濕度0%。又稱NTP，此時1m³之空氣重量為1.293kg。

馬力：性能表上所示之馬力為鼓風機入口狀態為STP狀態下所需馬達之額定馬力。非軸馬力。

η_{max}：最高效率點。選擇機型時儘量靠近最高效率點，可使鼓風機的運轉點效率高，噪音低。

● 將操作規格換算為型錄上的規格：

型錄上的風量為入口風量，靜壓指出口壓力(入口氣體為標準狀態空氣)。若操作規格不同於上述條件，其換算方式如下：

風量 Capacity (Q):

風量為基準狀態(NTP)時，須依下式換算：

When capacity is Q_N (NTP) condition, it should be converted as follow:

$$Q = Q_N \times \frac{273 + T_1}{273} \times \frac{10332}{P_1 - 0.378 \phi \text{ Psat}} \quad (\text{m}^3/\text{min})$$

靜壓 Static Pressure (Ps):

1. 入口溫度非 20°C

Temp of suction differs from 20°C

$$Ps = Ps_0 \times \frac{273 + t_1}{293} \quad (\text{mmAq})$$

2. 靜壓為入口負壓時必須換算為出口正壓

When static pressure is at vacuum (suction) condition

$$Ps = Ps_0 \times \frac{10332}{10332 - Ps_0} \quad (\text{mmAq})$$

● 鼓風機相似定律：

$$\frac{Q_2}{Q_1} = \frac{N_2}{N_1}$$

$$\frac{Ps_2}{Ps_1} = \left(\frac{N_2}{N_1}\right)^2 = \frac{\gamma_2}{\gamma_1}$$

$$\frac{HP_2}{HP_1} = \left(\frac{N_2}{N_1}\right)^3 = \frac{\gamma_2}{\gamma_1}$$

● Terminology in Catalog

Capacity: It means capacity at inlet condition.

Static pressure: The pressure at outlet (STP at inlet)

STP: 20°C, 760mmHg, 65% RH,

$$\gamma = 1.2\text{kg/m}^3$$

NTP: 0°C, 760mmHg, 0% RH,

$$\gamma = 1.293\text{kg/m}^3$$

Power: The power in performance charts are the required motor rated HP, not the brake horse power.

η_{max}: The highest efficiency point. It is recommended to choose the model nearing this point.

● To Change the Operating Specifications to the Specifications in Catalog

The capacity in catalog is inlet capacity.

The static pressure is outlet pressure (Inlet gas is STP air). If the operation specifications differ from above conditions. They can be changed according to following formulas:

Q(m³/min): 型錄上所示風量
Capacity in catalog

Q_N(Nm³/min): 基準狀態下之風量
Capacity at NTP condition

t₁(°C): 鼓風機入口溫度
Temp. at blower inlet.

Ps(mmAq): 型錄上所示靜壓
Static pressure in catalog

Ps₀(mmAq): 操作靜壓
Operating static pressure

P₁(mmAq): 入口絕對壓力
Inlet absolute pressure

φ(%): 相對濕度
Relative humidity

Psat(mmAq): 飽和蒸汽壓力
Saturated vapor pressure

● Blower Similarity Laws

Q : 風量 Capacity

Ps : 靜壓 Static pressure

HP : 馬力 Power

N : 鼓風機轉速 Blower RPM

γ : 空氣比重量 Gas density

機型說明 Model Instruction

● "DT-1000 系列單吸式送排風機依風量大小可分為 11 種機型：
There are 11 models in DT-1000 series single suction fans:

DT-1000S ~ DT-2000S

● 選擇步驟 Selection procedure:

1. 依需求風量和靜壓選擇最適當機型

Choose the most suitable model by capacity and pressure

2. 決定風機轉速 RPM

Chose the right RPM

3. 額定馬力 = BHPx1.15~1.20

Motor rated = BHPx1.15~1.20

選擇例：Example:

已換算至入口為標準狀態下風量 Q=1450m³/min

靜壓 Ps=250mmAq

Model A:DT-1300S Speed:1200RPM BHP:117HP

Motor rated:117HPx1.15=135HP → 150HP

Model B:DT-1500S Speed:950RPM BHP:107HP

Motor rated:107HPx1.15=123HP → 125HP

以上兩種機型均可使用，但機型A較便宜，軸馬力較高，以後的運轉費用亦高。機型B價格較高，但運轉費用較低，如果長時間使用，應選擇機型B較為經濟。

綜合性能表 General Performance

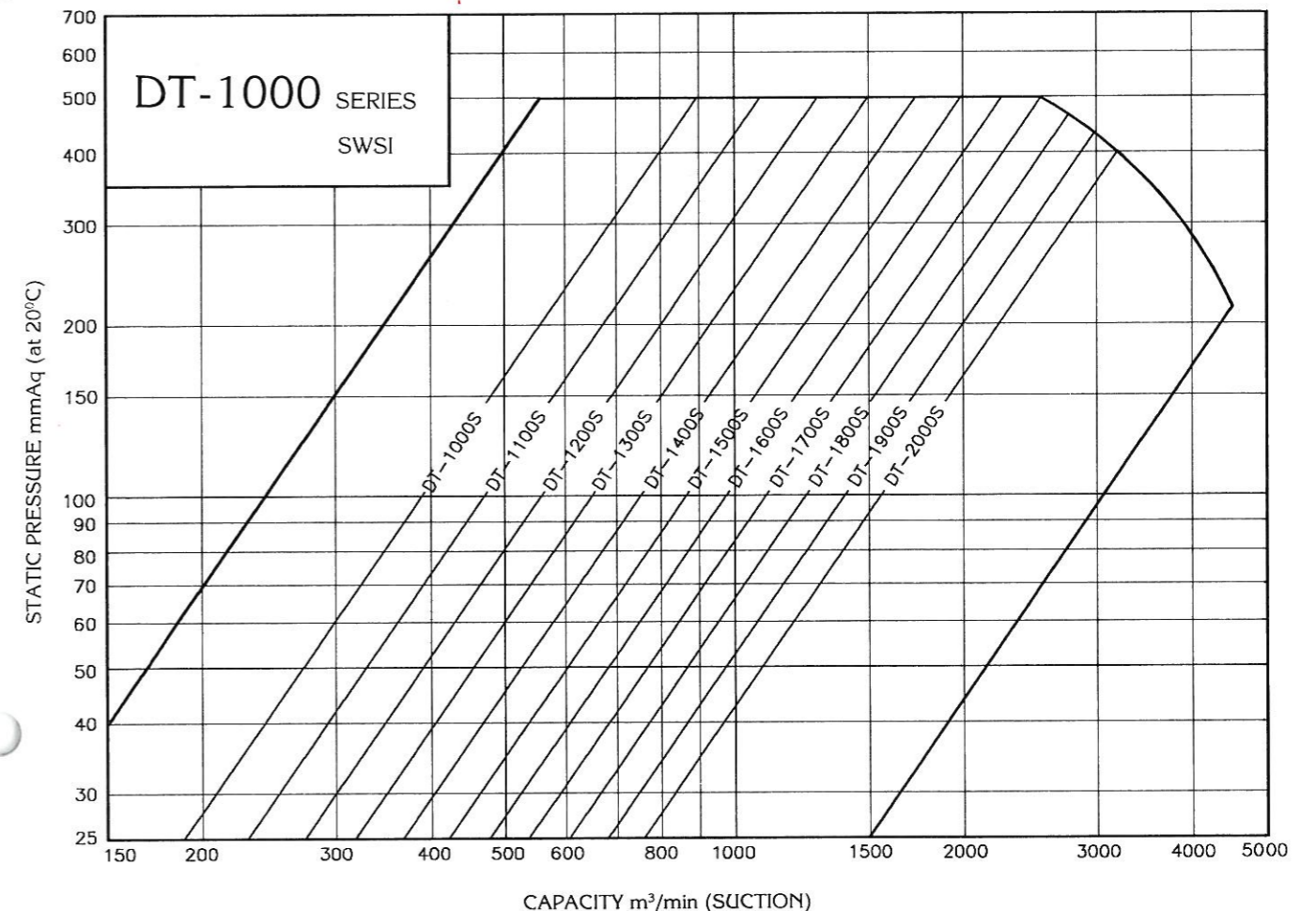

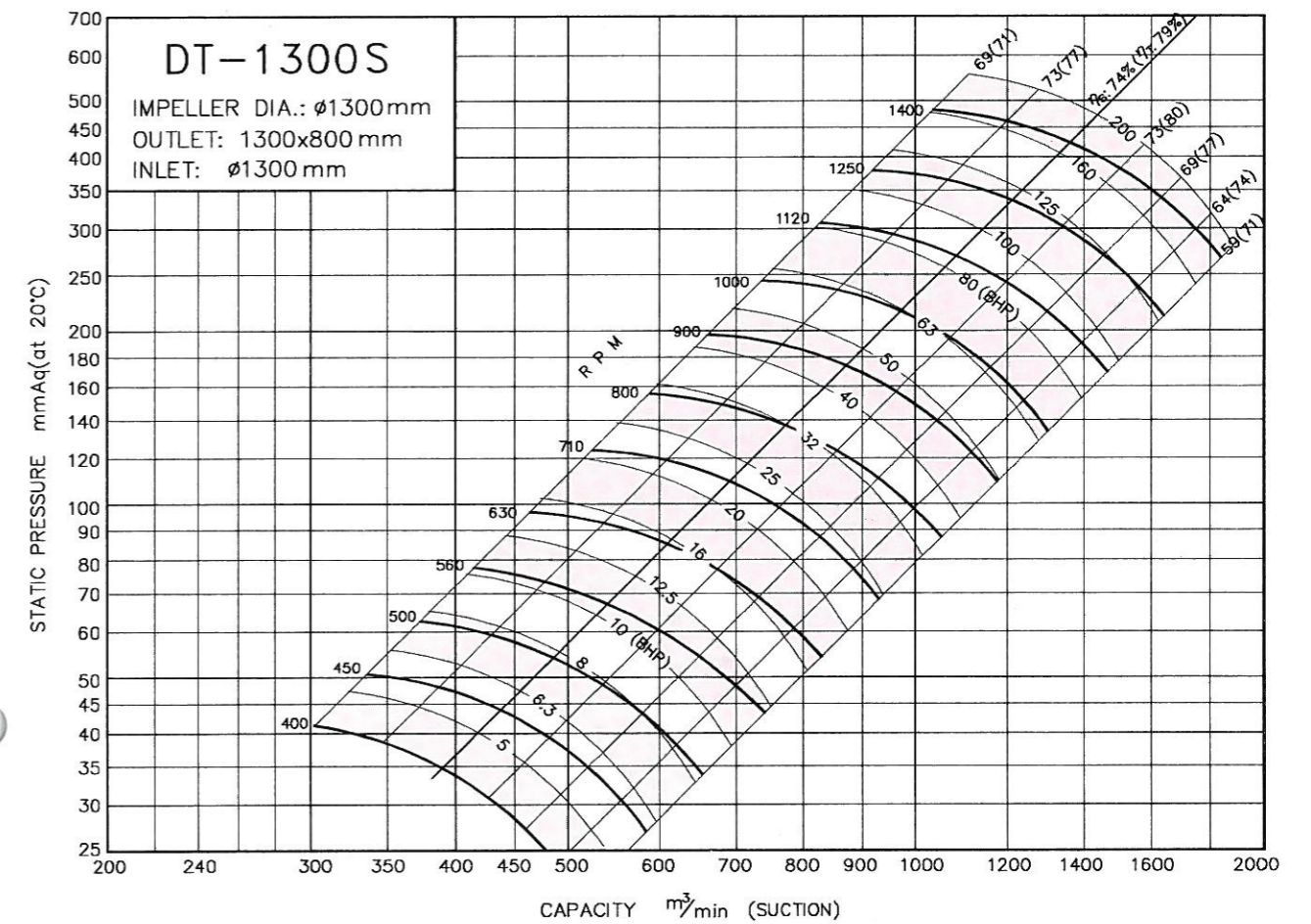
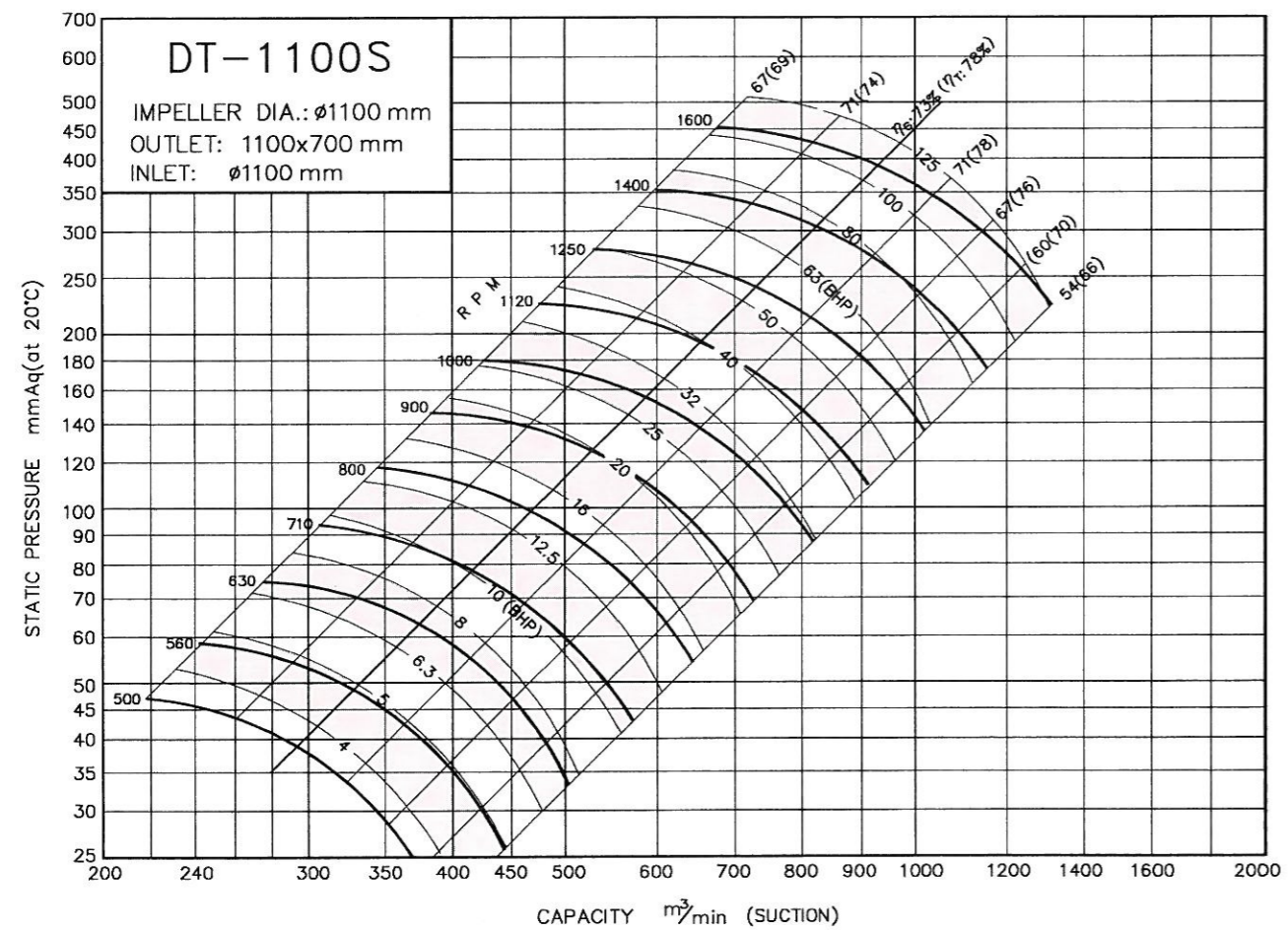
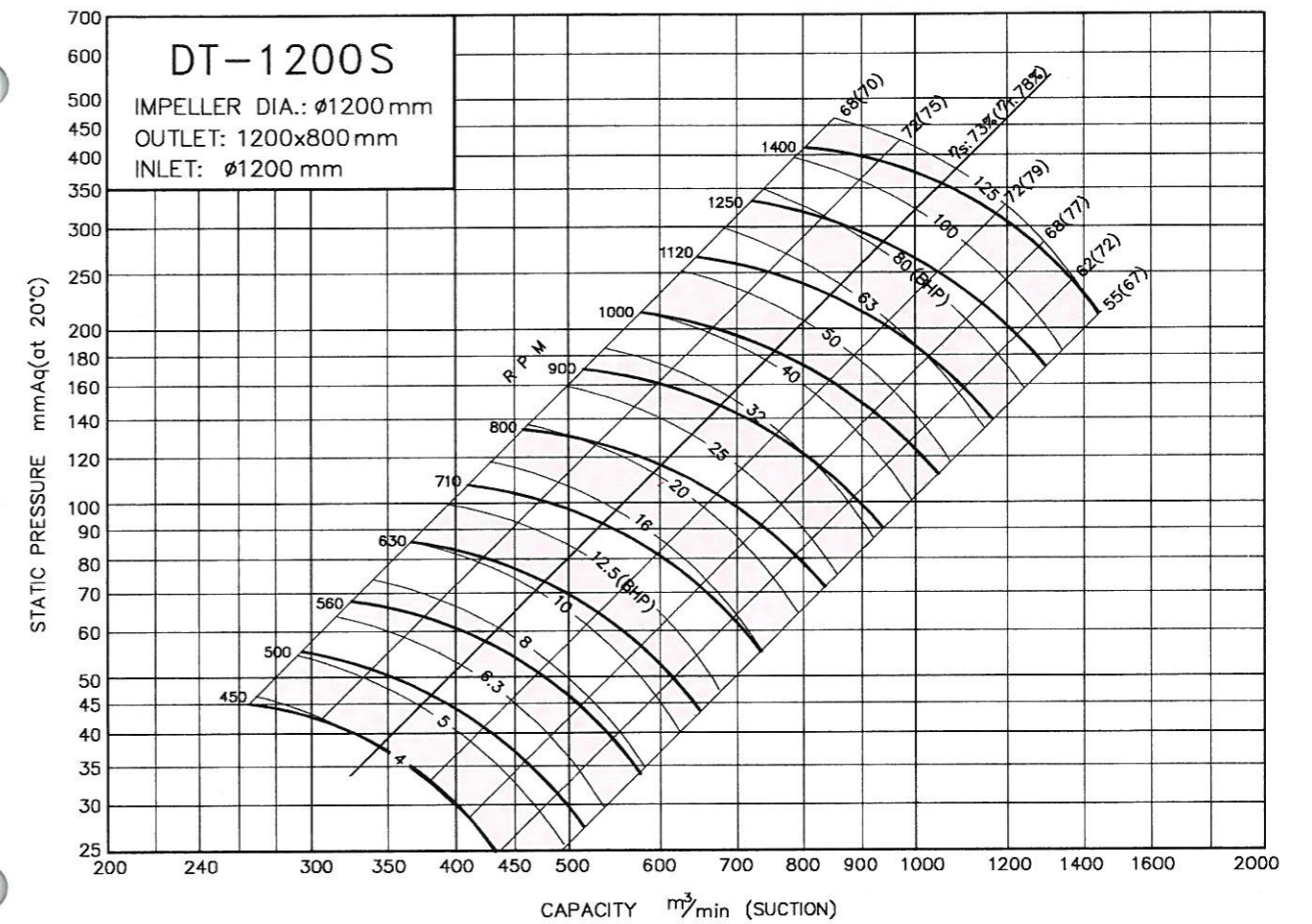
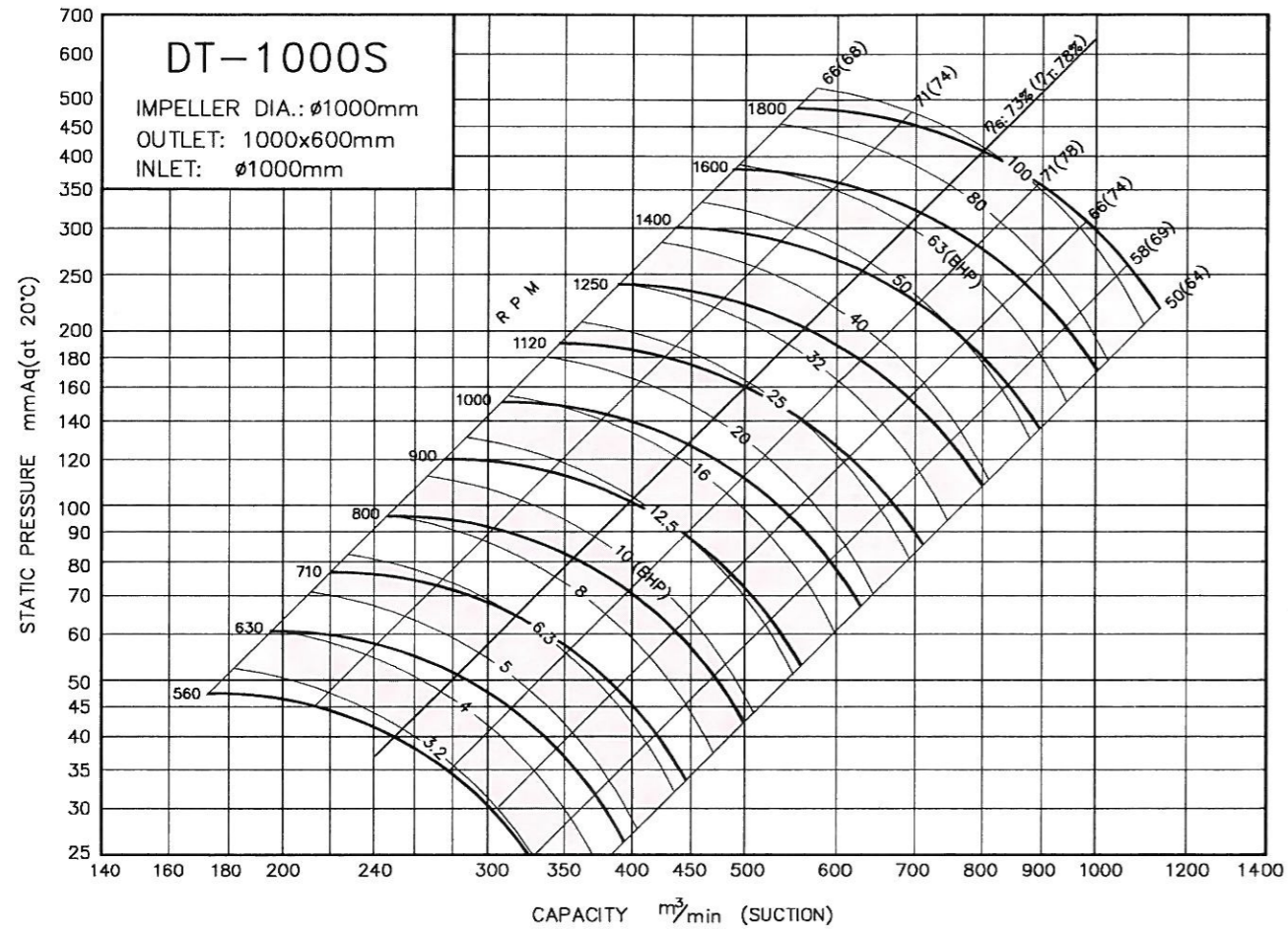

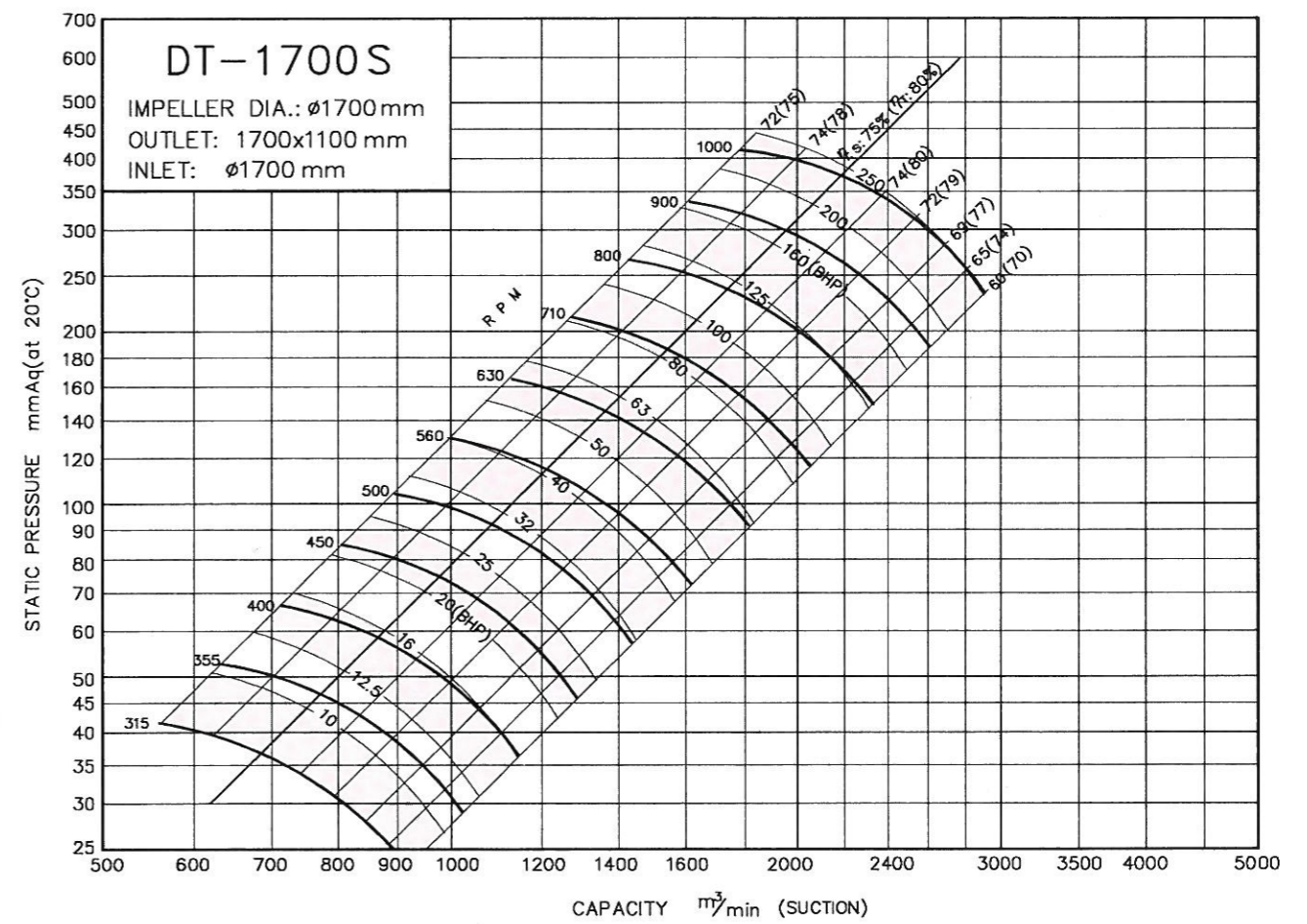
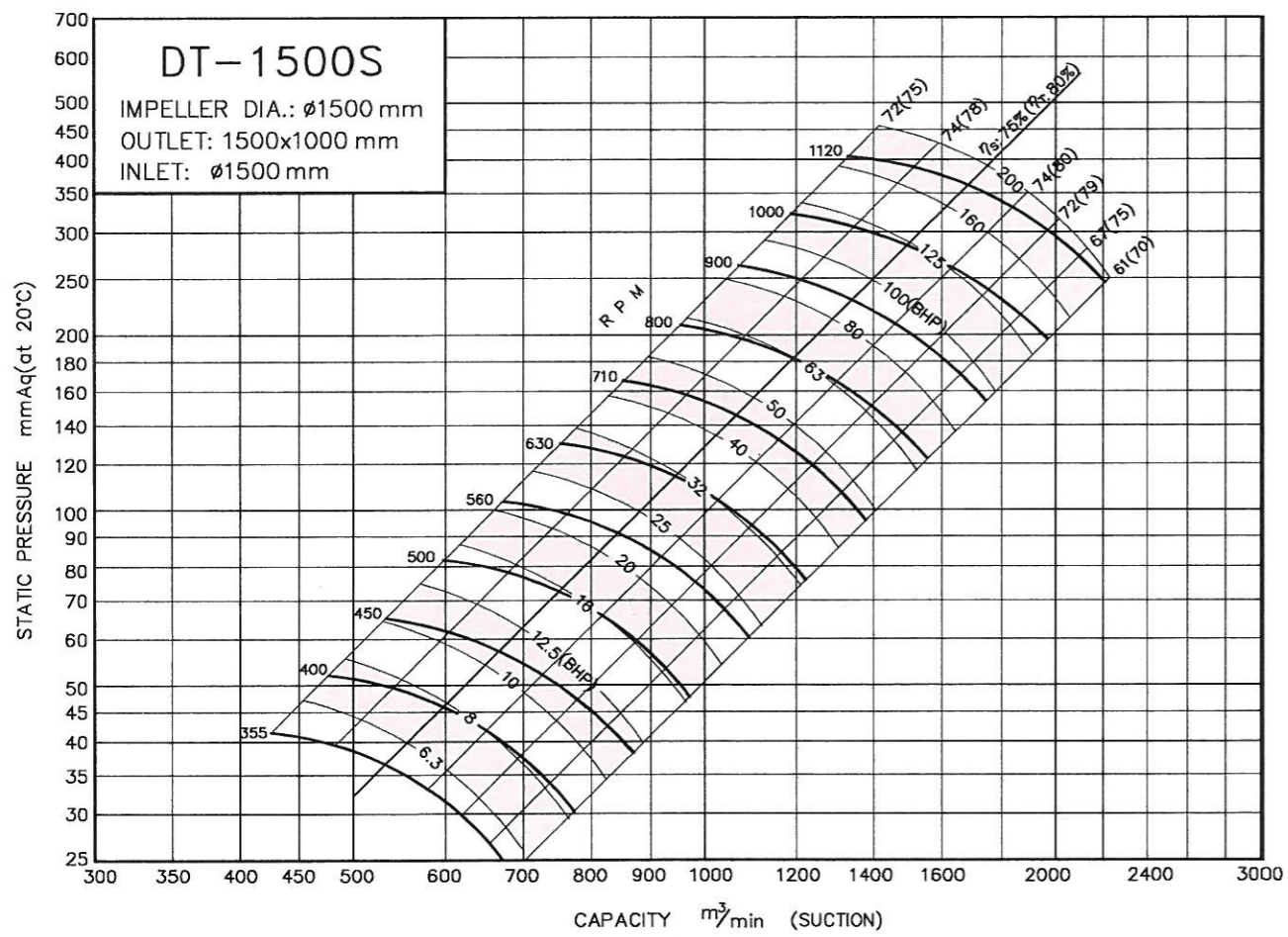
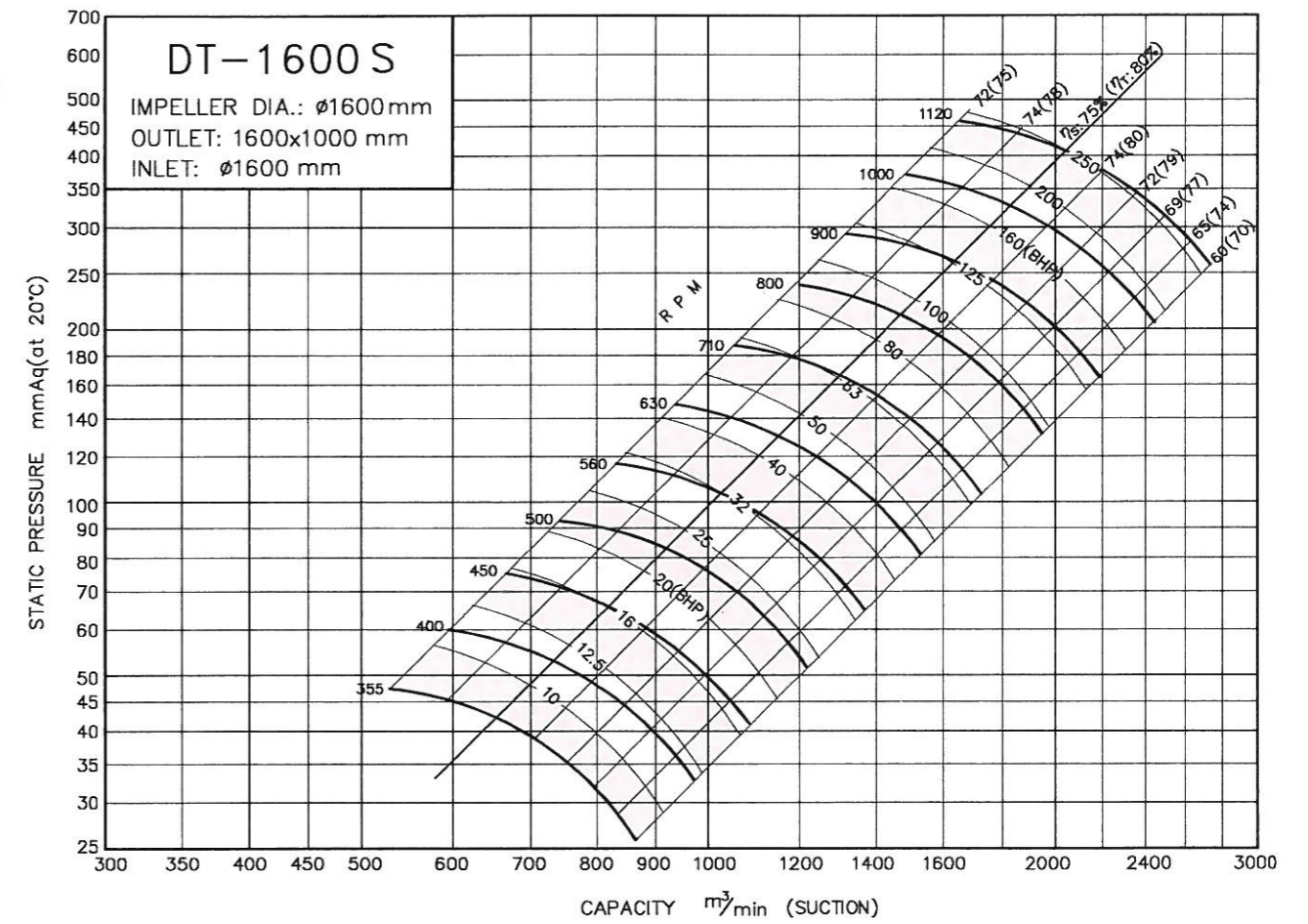
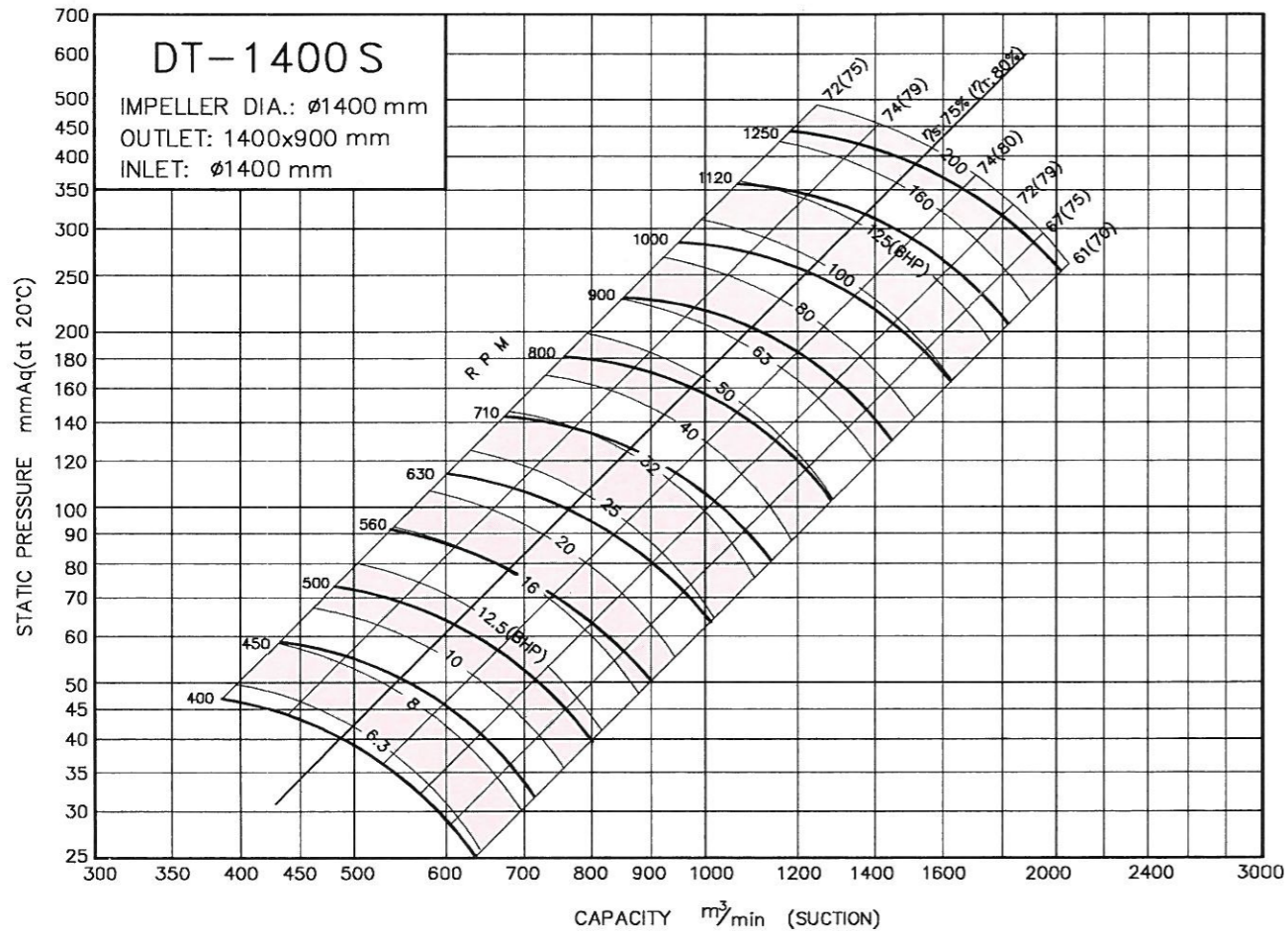

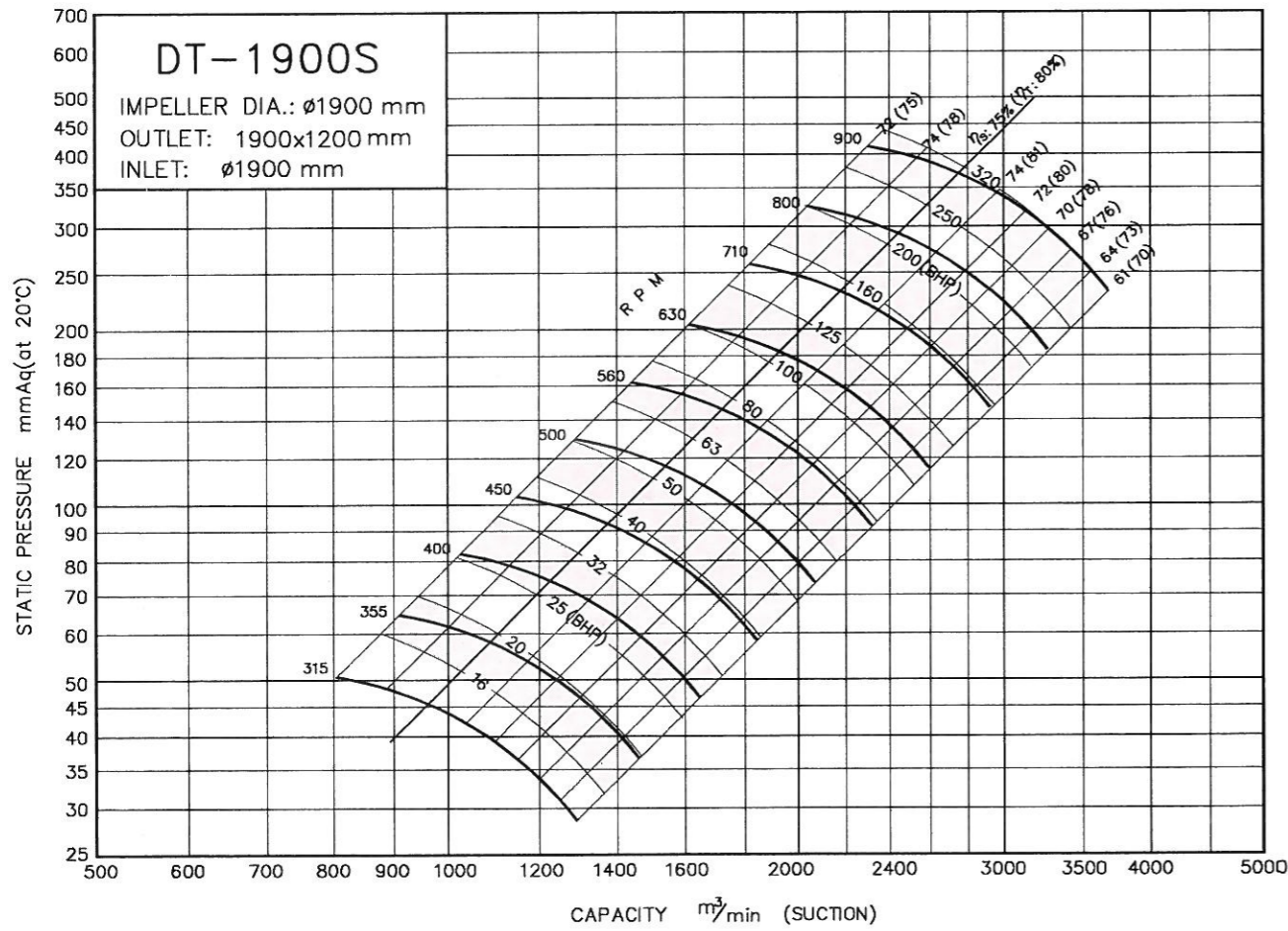
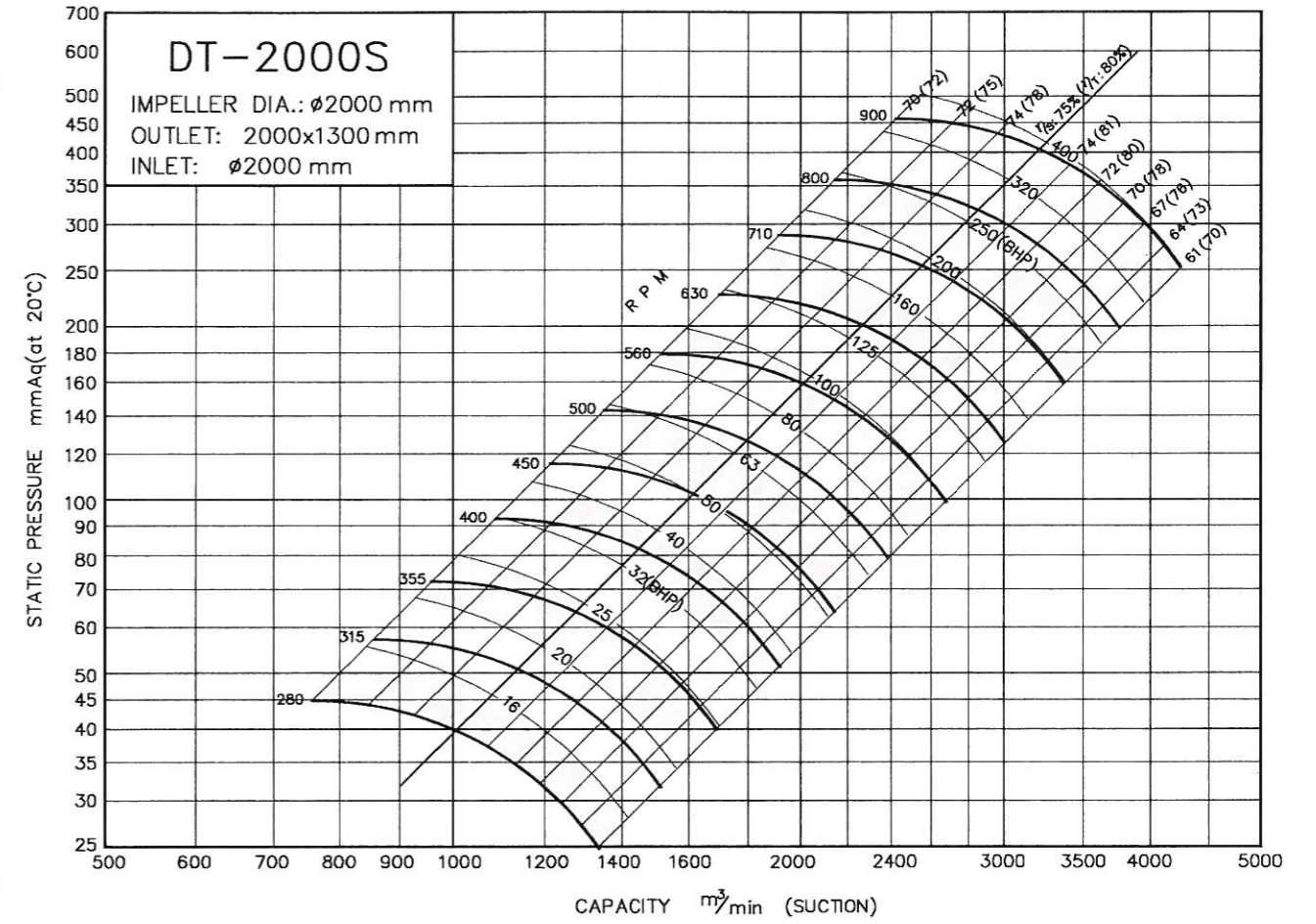
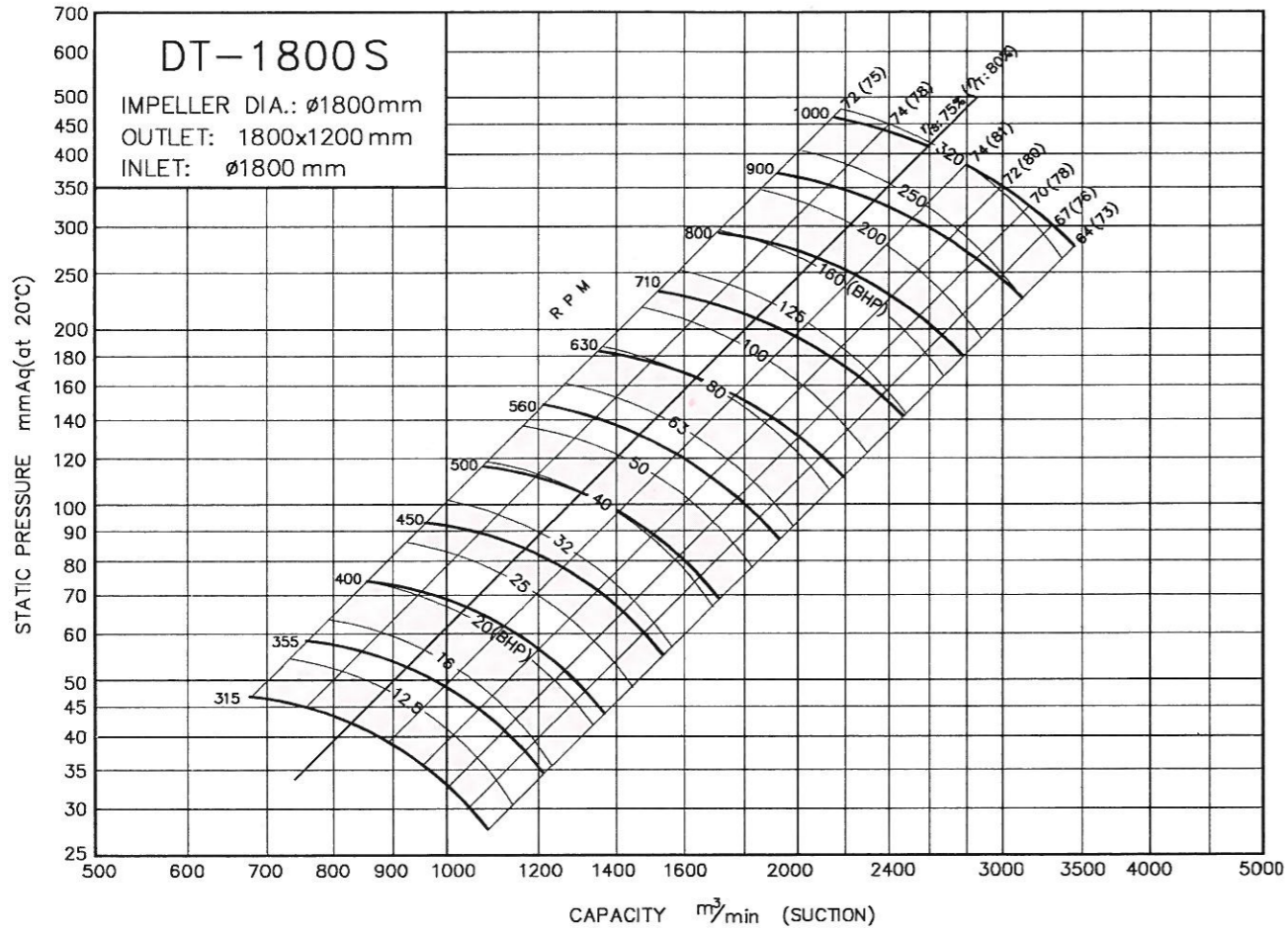

● 鼓風機振動容許值
 The Vibration Allowance of Blower

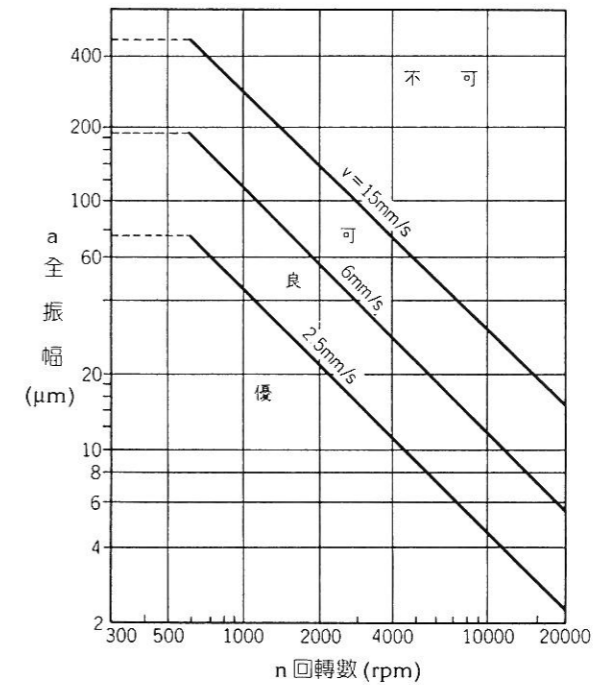

全振幅 a (μm) 和振動速度 v (mm/s) 的關係

$$v = \frac{\mu \omega}{2 \times 10^3} = \frac{a \pi n}{6 \times 10^4} \quad \omega: \text{角速度} = \frac{2 \pi n}{60} \text{ (rad/s)}$$

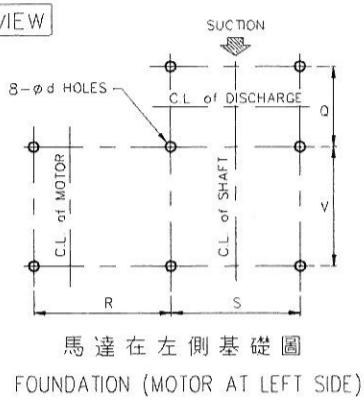
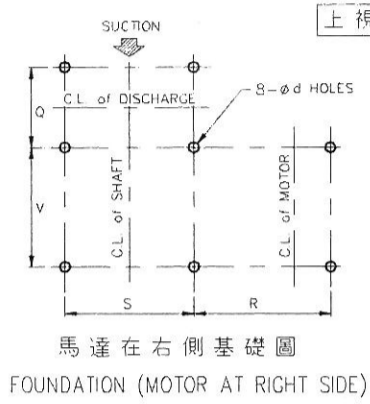
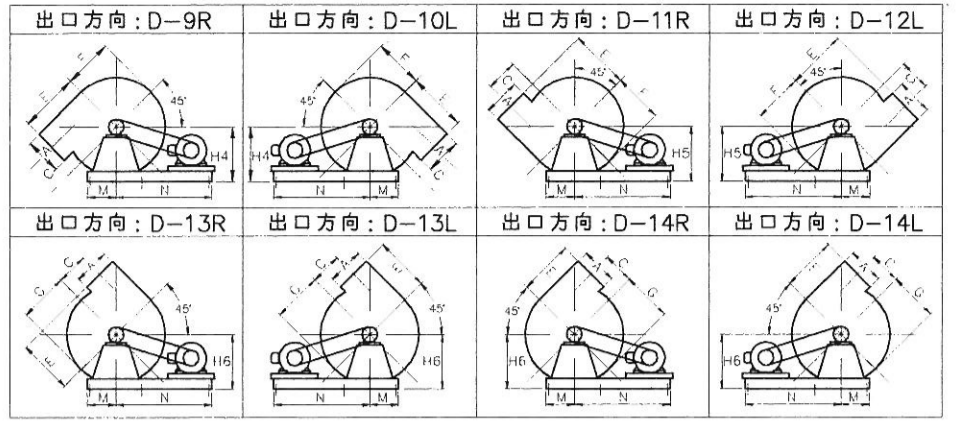
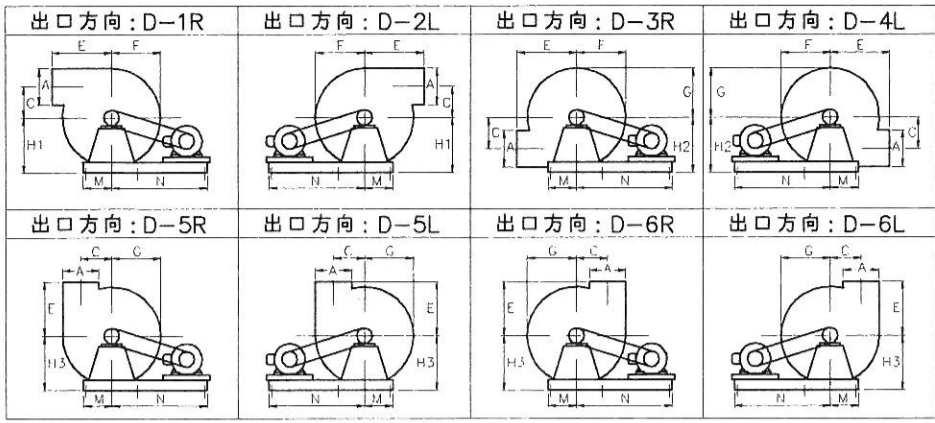

右側視圖 RIGHT SIDE VIEW

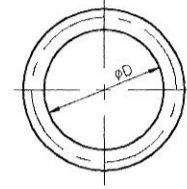
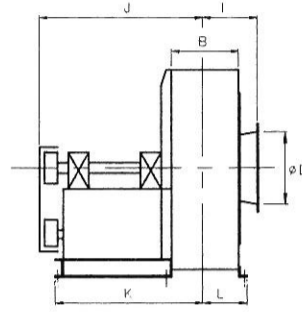

入口尺寸 (管外徑)
SUCTION (O.D.)

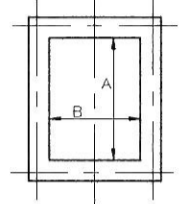

出口尺寸 (管外徑)
DISCHARGE (O.D.)

HP	15,20	25,30	40,50,60,75	100,125	150,175,200,250
BEARINGS	22215K+H	22215K+H	22217K+H	22219K+H	22222K+H
COMMON BASE	[125x65x6	[125x65x6	[125x65x6	[150x75x6.5	[150x75x6.5

MODEL	HP	4P	A	B	C	ØD	E	F	G	H1	H2	H3	H4	H5	H6	I	J	K	L	M	N	Q	R	S	V	Ød	略重 kg (不含) 馬達
										D-1 D-2	D-3 D-4	D-5 D-6	D-9 D-10	D-11 D-12	D-13 D-14												
DT-1000S	7.5, 10		1000	600	600	1000	700	1010	860	900	1250	1050	800	1100	950	390	1250	1085	365	500	1200	670	700	940	720	19	700
	15, 20		1000	600	600	1000	700	1010	860	900	1250	1050	800	1100	950	390	1250	4085	365	500	1200	670	700	940	720	19	700
	25, 30		1000	600	600	1000	700	1010	860	900	1250	1050	800	1100	950	390	1250	1085	365	500	1200	670	700	940	720	19	700
	40,50,60,75		1000	600	600	1000	700	1010	860	900	1250	1050	800	1100	950	390	1400	1245	365	500	1350	670	850	940	880	19	800
	100, 125		1000	600	600	1000	700	1010	860	900	1250	1050	800	1100	950	390	1500	1355	375	500	1500	690	1000	940	980	24	900
DT-1100S	7.5, 10		1100	700	660	1100	800	1050	885	950	1350	1100	850	1200	1000	440	1300	1135	415	550	1200	770	650	1040	720	19	800
	15, 20		1100	700	660	1100	800	1050	885	950	1350	1100	850	1200	1000	440	1300	1135	415	550	1200	770	650	1040	720	19	800
	25, 30		1100	700	660	1100	800	1050	885	950	1350	1100	850	1200	1000	440	1300	1135	415	550	1200	770	650	1040	720	19	800
	40,50,60,75		1100	700	660	1100	800	1050	885	950	1350	1100	850	1200	1000	440	1450	1295	415	550	1350	770	800	1040	880	19	900
	100, 125		1100	700	660	1100	800	1050	885	950	1350	1100	850	1200	1000	440	1550	1405	425	550	1500	790	950	1040	980	24	1000
DT-1200S	15, 20		1200	800	720	1200	850	1145	965	1000	1450	1200	900	1250	1100	490	1350	1185	465	600	1200	870	600	1140	720	19	900
	25, 30		1200	800	720	1200	850	1145	965	1000	1450	1200	900	1250	1100	490	1350	1185	465	600	1200	870	600	1140	720	19	900
	40,50,60,75		1200	800	720	1200	850	1145	965	1000	1450	1200	900	1250	1100	490	1500	1345	465	600	1350	870	750	1140	880	19	1000
	100,125		1200	800	720	1200	850	1145	965	1000	1450	1200	900	1250	1100	490	1600	1455	475	600	1500	890	900	1140	980	24	1100
	150,175,200		1200	800	720	1200	850	1145	965	1000	1450	1200	900	1250	1100	490	1760	1555	475	600	1650	890	1050	1140	1080	24	1200
DT-1300S	15, 20		1300	800	780	1300	900	1235	1035	1100	1600	1300	950	1350	1150	490	1350	1185	465	650	1350	870	700	1240	720	19	1100
	25, 30		1300	800	780	1300	900	1235	1035	1100	1600	1300	950	1350	1150	490	1350	1185	465	650	1350	870	700	1240	720	19	1100
	40,50,60,75		1300	800	780	1300	900	1235	1035	1100	1600	1300	950	1350	1150	490	1500	1345	465	650	1500	870	850	1240	880	19	1200
	100, 125		1300	800	780	1300	900	1235	1035	1100	1600	1300	950	1350	1150	490	1600	1455	475	650	1650	890	1000	1240	980	24	1300
	150,175,200		1300	800	780	1300	900	1235	1035	1100	1600	1300	950	1350	1150	490	1760	1555	475	650	1800	890	1150	1240	1080	24	1400
DT-1400S	15, 20		1400	900	840	1400	1000	1340	1130	1200	1700	1400	1050	1500	1250	540	1400	1235	515	700	1350	970	650	1340	720	19	1300
	25, 30		1400	900	840	1400	1000	1340	1130	1200	1700	1400	1050	1500	1250	540	1400	1235	515	700	1350	970	650	1340	720	19	1300
	40,50,60,75		1400	900	840	1400	1000	1340	1130	1200	1700	1400	1050	1500	1250	540	1550	1395	515	700	1500	970	800	1340	880	19	1400
	100, 125		1400	900	840	1400	1000	1340	1130	1200	1700	1400	1050	1500	1250	540	1650	1505	525	700	1650	990	950	1340	980	24	1500
	150,175,200		1400	900	840	1400	1000	1340	1130	1200	1700	1400	1050	1500	1250	540	1810	1605	525	700	1800	990	1100	1340	1080	24	1600

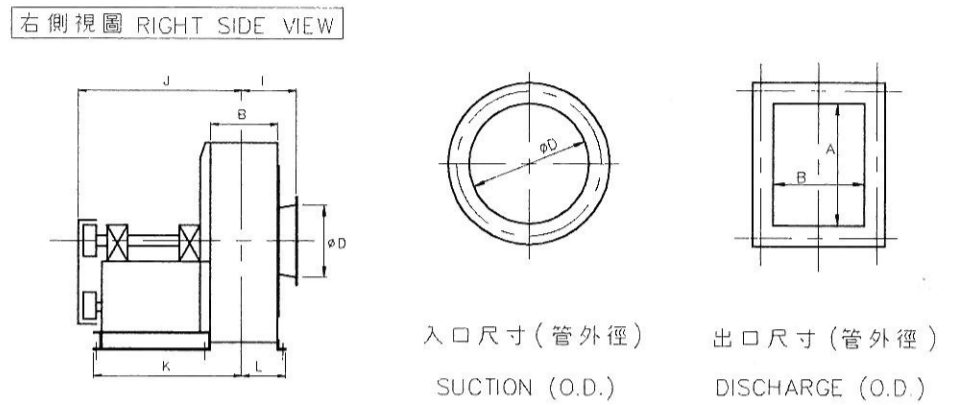
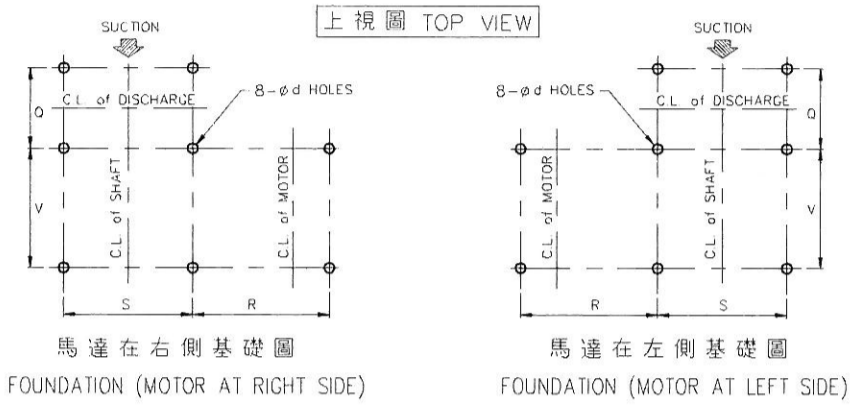
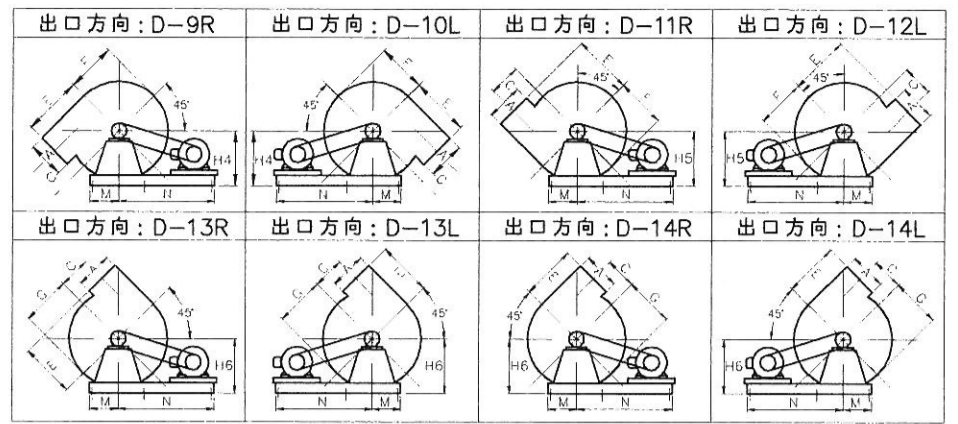
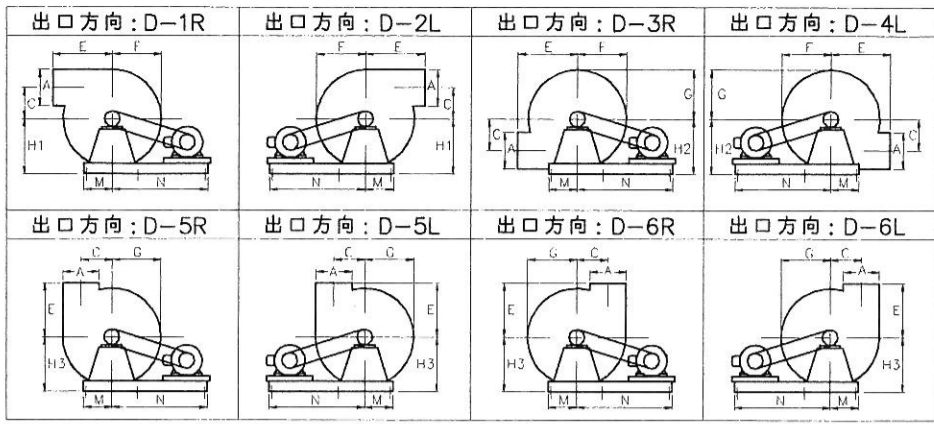

HP	15,20	25,30	40,50,60,75	100,125	150,175,200,250	320,400
BEARINGS	22215K+H	22215K+H	22217K+H	22219K+H	22222K+H	22224K+H
COMMON BASE	[125x65x6	[125x65x6	[125x65x6	[150x75x6.5	[150x75x6.5	[200x80x7.5

MODEL	HP	4P	A	B	C	øD	E	F	G	H						I	J	K	L	M	N	Q	R	S	V	ød	略重 kg (不含 馬達)
										D-1 D-2	D-3 D-4	D-5 D-6	D-9 D-10	D-11 D-12	D-13 D-14												
DT-1500S	15, 20		1500	1000	900	1500	1050	1425	1200	1250	1800	1500	1150	1600	1350	590	1450	1285	565	750	1350	1070	600	1440	720	19	1500
	25, 30		1500	1000	900	1500	1050	1425	1200	1250	1800	1500	1150	1600	1350	590	1450	1285	565	750	1350	1070	600	1440	720	19	1500
	40,50,60,75		1500	1000	900	1500	1050	1425	1200	1250	1800	1500	1150	1600	1350	590	1600	1445	565	750	1500	1070	750	1440	880	19	1600
	100, 125		1500	1000	900	1500	1050	1425	1200	1250	1800	1500	1150	1600	1350	590	1700	1555	575	750	1650	1090	900	1440	980	24	1700
	150,175,200		1500	1000	900	1500	1050	1425	1200	1250	1800	1500	1150	1600	1350	590	1860	1655	575	750	1800	1090	1050	1440	1080	24	1800
DT-1600S	25, 30		1600	1000	960	1600	1150	1525	1285	1350	1900	1600	1200	1700	1450	590	1450	1285	565	800	1500	1070	700	1540	720	19	1700
	40,50,60,75		1600	1000	960	1600	1150	1525	1285	1350	1900	1600	1200	1700	1450	590	1600	1445	565	800	1650	1070	850	1540	880	19	1800
	100, 125		1600	1000	960	1600	1150	1525	1285	1350	1900	1600	1200	1700	1450	590	1700	1555	575	800	1800	1090	1000	1540	980	24	1900
	150,175,200,250		1600	1000	960	1600	1150	1525	1285	1350	1900	1600	1200	1700	1450	590	1860	1655	575	800	1950	1090	1150	1540	1080	24	2000
DT-1700S	25, 30		1700	1100	1020	1700	1200	1625	1375	1450	2050	1700	1300	1800	1550	640	1500	1355	615	850	1500	1170	650	1640	720	19	1900
	40,50,60,75		1700	1100	1020	1700	1200	1625	1375	1450	2050	1700	1300	1800	1550	640	1650	1495	615	850	1650	1170	800	1640	880	19	2100
	100, 125		1700	1100	1020	1700	1200	1625	1375	1450	2050	1700	1300	1800	1550	640	1750	1605	625	850	1800	1190	950	1640	980	24	2300
	150,175,200,250		1700	1100	1020	1700	1200	1625	1375	1450	2050	1700	1300	1800	1550	640	1910	1705	625	850	1950	1190	1100	1640	1080	24	2500
DT-1800S	40,50,60,75		1800	1200	1080	1800	1300	1730	1470	1500	2150	1800	1400	1900	1650	690	1700	1545	665	900	1800	1270	900	1740	880	19	2400
	100, 125		1800	1200	1080	1800	1300	1730	1470	1500	2150	1800	1400	1900	1650	690	1800	1655	675	900	1950	1290	1050	1740	980	24	2600
	150,175,200,250		1800	1200	1080	1800	1300	1730	1470	1500	2150	1800	1400	1900	1650	690	1960	1755	675	900	2100	1290	1200	1740	1080	24	2800
	320		1800	1200	1080	1800	1300	1730	1470	1500	2150	1800	1400	1900	1650	690	2165	1860	680	900	2250	1300	1350	1740	1180	28	3000
DT-1900S	40,50,60,75		1900	1200	1140	1900	1350	1825	1540	1600	2300	1900	1450	2050	1800	690	1700	1545	665	950	1800	1270	850	1840	880	19	2900
	100,125		1900	1200	1140	1900	1350	1825	1540	1600	2300	1900	1450	2050	1800	690	1800	1655	675	950	1950	1290	1000	1840	980	24	3100
	150,175,200,250		1900	1200	1140	1900	1350	1825	1540	1600	2300	1900	1450	2050	1800	690	1960	1755	675	950	2100	1290	1150	1840	1080	24	3300
	320,400		1900	1200	1140	1900	1350	1825	1540	1600	2300	1900	1450	2050	1800	690	2165	1860	680	950	2250	1300	1300	1840	1180	28	3500
DT-2000S	40,50,60,75		2000	1300	1200	2000	1400	1920	1620	1650	2400	2000	1500	2150	1850	740	1750	1595	715	1000	1800	1370	800	1940	880	19	3400
	100, 125		2000	1300	1200	2000	1400	1920	1620	1650	2400	2000	1500	2150	1850	740	1850	1705	725	1000	1950	1390	950	1940	980	24	3600
	150,175,200,250		2000	1300	1200	2000	1400	1920	1620	1650	2400	2000	1500	2150	1850	740	2010	1805	725	1000	2100	1390	1100	1940	1080	24	3800
	320,400		2000	1300	1200	2000	1400	1920	1620	1650	2400	2000	1500	2150	1850	740	2215	1910	730	1000	2250	1400	1250	1940	1180	28	4000

風量控制 出口開關 Discharge Damper Flow Control

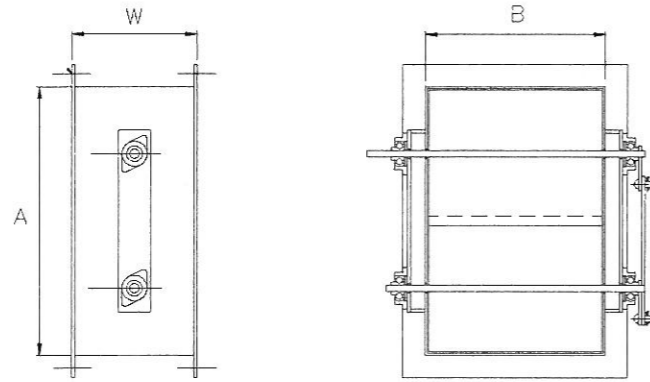
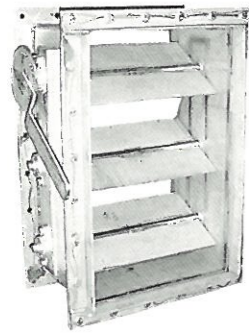

A	1000	1100	1200	1300	1400	1500	1600	1700	1800	1900	2000
B	600	700	800	800	900	1000	1100	1100	1200	1200	1300
W	300	300	300	350	350	350	350	350	350	400	400

入口開關 Suction Damper

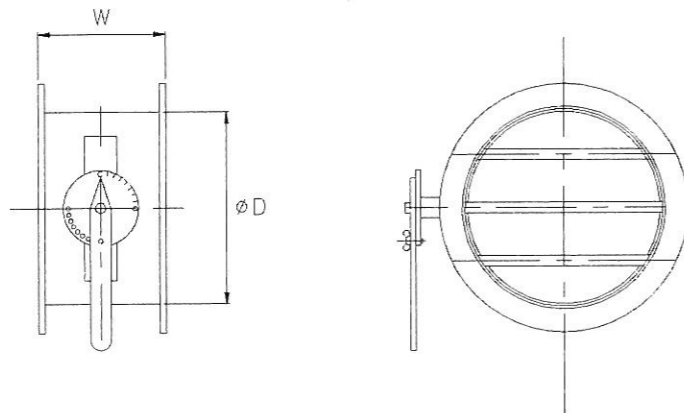
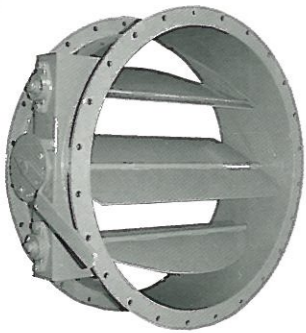

φ D	1000	1100	1200	1300	1400	1500	1600	1700	1800	1900	2000
W	350	350	400	400	400	450	450	450	450	500	500

入口扇形開關 Inlet Vane Controller (IVC)

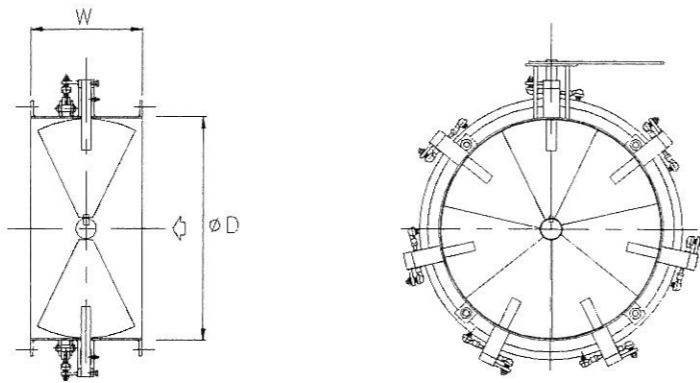

φ D	1000	1100	1200	1300	1400	1500	1600	1700	1800	1900	2000
W	350	350	350	400	400	400	400	400	400	400	400

訂製資料 IN Making Purchase or Enquiry

- 用途及使用狀況：**
說明用途、使用場所及運轉的情形，例如連續運轉或間歇性運轉。
- 風量：**
說明要求的風量是在標準狀態（一大氣壓、20°C）、相對濕度 65%）或基準狀態，除非特別說明，一般均指入口狀態而非出口狀態。
- 壓力：**
需註明使用壓力是否穩定在一特定的壓力值或壓力隨時在改變。假如壓力有變化，請說明壓力改變和風量的相對關係。如壓力下降則風量增大，反之則風量減少。並訂出其變化的範圍。所訂定的壓力是指出口的靜壓或是出入口的壓差均須標明，還有入口壓力是否在一大氣壓下，如非一大氣壓請註明其出入口的壓力。
- 輸送氣體の種類及其比重：**
請標明下列各項：
a. 氣體種類及其成分。
b. 其它物質的成分及其大小。
c. 比重。
d. 化學性質。
e. 建議使用材質。
f. 是否有爆炸性或毒性。
如無註明上列事項，將以一般空氣處理之。
- 氣體溫度：**
達勝透浦鼓風機的標準規格品是用來輸送入口溫度為常溫的氣體，如入口使用溫度高於常溫，請告知本公司，以便作特殊設計以適用於高溫狀態。
- 原動機：**
如使用馬達帶動，請告知電源電壓、頻率、單相或三相。
- 塗裝：**
本公司標準塗裝色為 # 3 如有特別指定色，請告知。

- Application and conditions**
Describe the purpose of use, continuous or intermittent operation.
- Flow Rate**
Describe whether the flow rate is at standard condition or normal condition (unless specified, the flow rate will be calculated as a flow rate under suction condition, and it is not handled as discharge flow rate i.e. at 760mm Hg, 20°C, 65% RH or standard condition.)
- Pressure**
Describe whether pressure is constant or variable, if variable, specify the range and the relationship between air flow rate and pressure. Describe whether pressure shows static pressure of the discharge or difference between suction and discharge pressure. State whether suction pressure is atmospheric pressure. Other wise, specify suction and discharge pressure respectively.
- Type of Gas and Specific Gravity**
Specify the following points: Type of gas and its components, content of impurities and their sizes, specific gravity, chemical properties, suggestions for materials, explosive and/or toxic nature (regarded as normal temperature, normal-pressure air unless specified).
- Gas Temperature**
DT series Turbo Fans are normally used for normal temperature at suction. If suction temperature is higher than normal temperature, please inform TA SHENG CO.
- Type of Prime Mover**
When a motor is used as the prime mover. Specify the voltage, frequency and power supply condition etc.
- Painting**
#3 is the standard color of DT series blower, if the painting is differ from above, please inform us.

單位換算 Unit Conversion

	壓力 Pressure						
	mbar	Pa	atm	lb/in ²	kgf/cm ²	in Hg	mmAq
1 mbar	1	10 ²	9.869x10 ⁻⁴	1.45x10 ⁻²	1.02x10 ⁻³	2.953x10 ⁻²	10.197
1 Pa	0.01	1	9.87x10 ⁻⁶	1.45x10 ⁻⁴	1.02x10 ⁻⁵	2.953x10 ⁻⁴	0.102
1 atm	1.013x10 ³	1.013x10 ⁵	1	14.7	1.033	29.92	1.033x10 ⁴
1 lb/in ²	68.951	6.8951x10 ²	6.805x10 ⁻²	1	7.03x10 ⁻²	2.036	7.03x10 ²
1 kgf/cm ²	9.807x10 ²	9.807x10 ⁴	0.968	14.22	1	28.96	10 ⁴
1 in Hg	33.86	3.386x10 ³	3.342x10 ⁻²	0.491	3.45x10 ⁻²	1	3.45x10 ²
1 mmAq	9.807x10 ⁻³	9.807	9.677x10 ⁻⁵	1.42x10 ⁻³	10 ⁻⁴	2.896x10 ⁻³	1

	風量 Capacity			
	m ³ /min	m ³ /hr	ℓ/min	ft ³ /min(cfm)
1m ³ /min	1	60	1000	35.31
1m ³ /hr	0.017	1	16.67	0.589
1ℓ/min	0.001	0.06	1	0.035
1ft ³ /min(cfm)	0.028	1.699	28.32	1

壓力常用換算公式
Pressure Conversion Formula
1 Pa=0.102 mmAq
1 daPa=10 Pa
1 mbar=10.197 mmAq
1 mmHg=13.6 mmAq
1 psi=703 mmAq
1 Torr=133.3 Pa
1 Torr=1.333 mbar

主要產品

Main Products

- ◆ 卡特鼓風機
- ◆ 氣密鼓風機
- ◆ 輸送用鼓風機
- ◆ 超低噪音鼓風機
- ◆ 防爆型鼓風機
- ◆ 耐磨耗鼓風機
- ◆ 耐腐蝕鼓風機
- ◆ 耐高溫鼓風機
- ◆ 工業用送排風機
- ◆ 多段式高壓鼓風機
- ◆ 單段式鑄造型鼓風機
- ◆ 多段鑄造型高壓鼓風機
- ◆ 不漏氣風門
- ◆ 送排風機及鼓風機各式附件
- ◆ 特殊型送排風機及鼓風機

- Cutter Blowers
- Gas Tight Blowers
- Conveyor Blowers
- Low Noise Blowers
- Explosion Proof Blowers
- Wear-Resistance Blowers
- Corrosion-Resistance Blowers
- High Temperature Resistance Blowers

- Mild Steel Fans & Blowers
- Mild Steel Multi-Steel Blowers
- Casting Blowers
- Casting Multi-Stage Blowers
- Leakless Dampers
- Accessories of Fan & Blowers
- Special Applications Fans & Blowers



達勝機械股份有限公司
TA SHENG MACHINERY CO.,LTD.

公司：台北縣泰山鄉明志路三段515號4樓
Office：4th fl., No.515, Sec.3, Min Chih Rd., Tai Shan Hsiang, Taipei Hsien, Taiwan.
TEL：02-29051986~9 FAX：02-29038152